

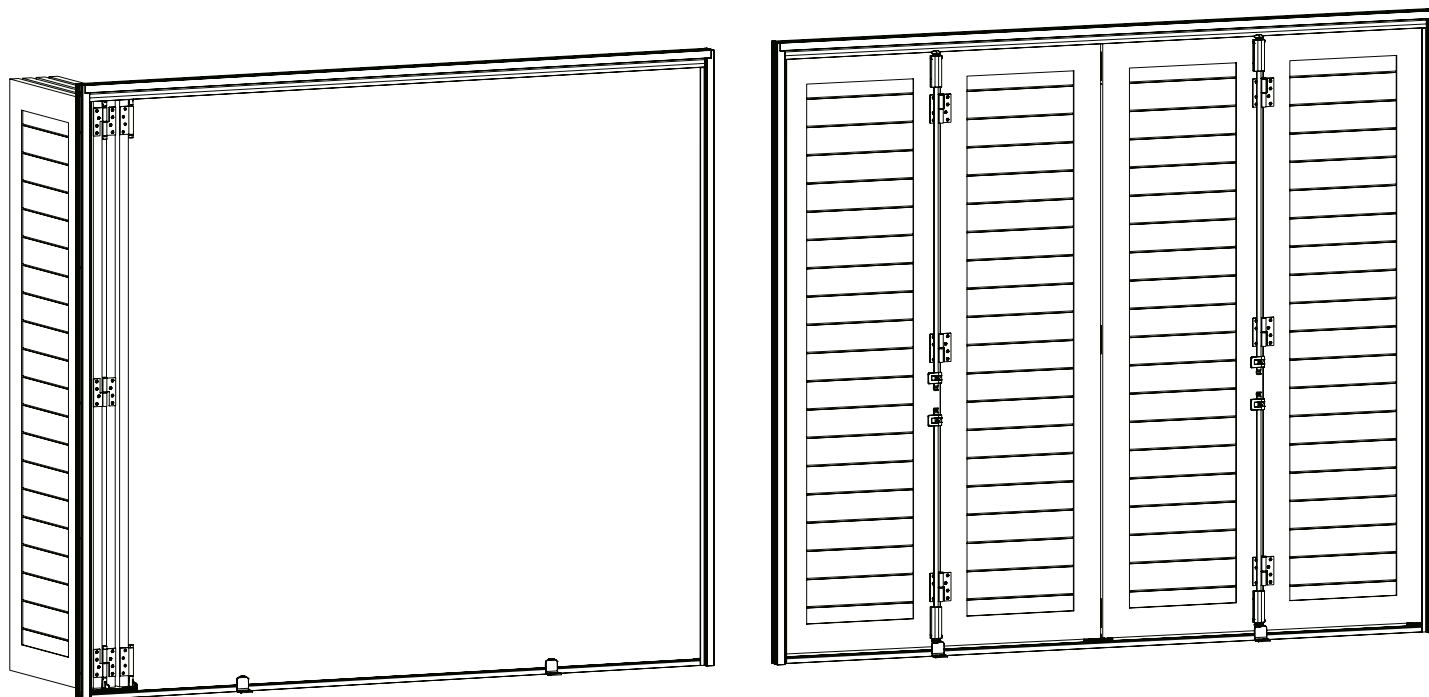

# Istruzioni di posa



Vista dall'interno



## Gamma VCP300

Ferramenta per persiane scorrevoli ripieghevoli  
Per configurazione 4+0 o 0+4

# Componenti

## PROFILI E ACCESSORI PER TELAIO IN ALLUMINIO

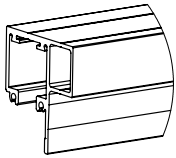

**A** VR10906

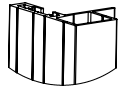

**B** VR10917

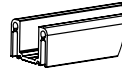

**C** VR10926

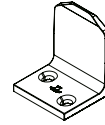

**D** VR10930

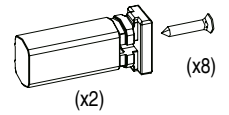

**E** VR10830  
(x8)

## SCORRIMENTO SUPERIORE

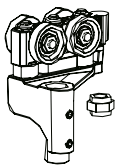

**F1** VR10100G

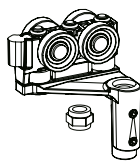

**F2** VR10200D

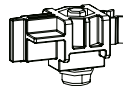

**G** VR10300

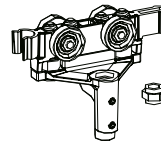

**H1** VR10700G

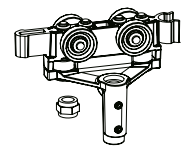

**H2** VR10600D

## SCORRIMENTO INFERIORE

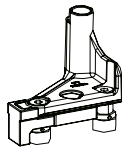

**I1** VR10400G

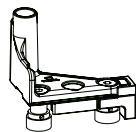

**I2** VR10500D

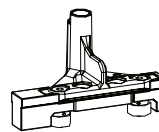

**J1** VR10800G

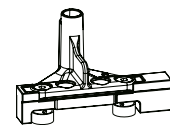

**J2** VR10801D

## COLLEGAMENTO PROFILI/ANTE

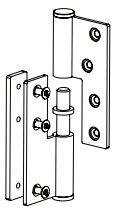

**K1** VR10821G

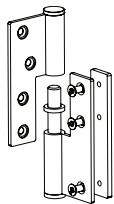

**K2** VR10822D

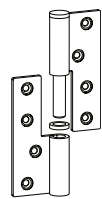

**L1** VR10809G

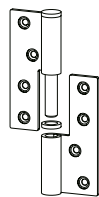

**L2** VR10810D

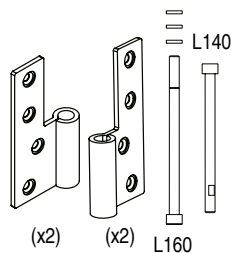

**M** VR10828

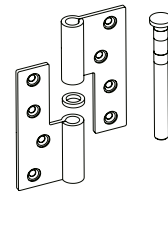

**N1** VR10816G

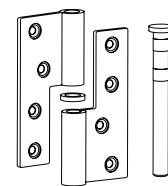

**N2** VR10817D

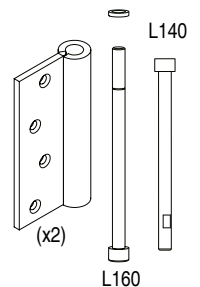

**O** VR10818

## CHIUSURA

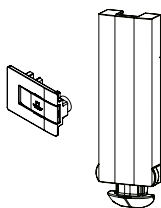

**P** VR10835



**Q** VR10837

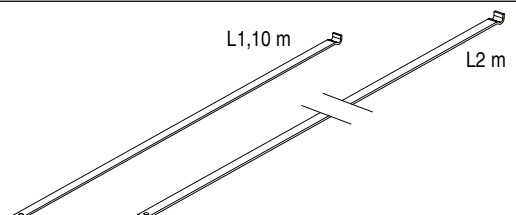

**R** VR10838J

**S** VR10839J

Descrizione		Codice	Conf.	H anta < 1800 mm		1800 <= H anta > 2800 mm		2800 <= H anta > = 3000 mm	
				4+0	0+4	4+0	0+4	4+0	0+4
				UnitÀ	UnitÀ	UnitÀ	UnitÀ	UnitÀ	UnitÀ
<b>PROFILI E ACCESSORI PER TELAIO IN ALLUMINIO</b>									
<b>A</b>	BINARIO SUPERIORE IN ALLUMINIO 6M	VR10906	9	1	1	1	1	1	1
<b>B</b>	PROFILO TELAIO LATERALE CON BATTUTA IN ALLUMINIO 6 M	VR10917	9	1	1	1	1	1	1
<b>C</b>	GUIDA A U INFERIORE IN ALLUMINIO 6M	VR10926	9	1	1	1	1	1	1
<b>D</b>	BATTUTA INFERIORE ZAMA PER GUIDA A U INFERIORE	VR10930	20	2	2	2	2	2	2
<b>E</b>	KIT 2 BATTUTE FISSE NYLON PER GUIDA INFERIORE + VITI	VR10830	20	1	1	1	1	1	1
<b>SCORRIMENTO SUPERIORE</b>									
<b>F1</b>	CARRELLO SUPERIORE ESTERNO SINISTRO VISTA INTERNA	VR10100G	20	1		1		1	
<b>F2</b>	CARRELLO SUPERIORE ESTERNO DESTRO VISTA INTERNA	VR10200D	20		1		1		1
<b>G</b>	BATTUTA CARRELLO SUPERIORE NYLON	VR10300	20	1	1	1	1	1	1
<b>H1</b>	CARRELLO SUPERIORE CENTRALE SINISTRO ZAMA	VR10700G	20	1		1		1	
<b>H2</b>	CARRELLO SUPERIORE CENTRALE DESTRO ZAMA	VR10600D	20		1		1		1
<b>SCORRIMENTO INFERIORE</b>									
<b>I1</b>	SLITTA INFERIORE TERMINALE SINISTRA VISTA INTERNA	VR10400G	20	1		1		1	
<b>I2</b>	SLITTA INFERIORE TERMINALE DESTRA VISTA INTERNA	VR10500D	20		1		1		1
<b>J1</b>	SLITTA INFERIORE CENTRALE SINISTRA VISTA INTERNA	VR10800G	20	1		1		1	
<b>J2</b>	SLITTA INFERIORE CENTRALE DESTRA VISTA INTERNA	VR10801D	20		1		1		1
<b>COLLEGAMENTO PROFILI/ANTE</b>									
<b>K1</b>	POMELLA PER TELAIO DESTRA VISTA INTERNA	VR10821G	20	2		3		4	
<b>K2</b>	POMELLA PER TELAIO SINISTRA VISTA INTERNA	VR10822D	20		2		3		4
<b>L1</b>	POMELLA CENTRALE PIATTA SINISTRA	VR10809G	10	2	2	4	2	6	2
<b>L2</b>	POMELLA CENTRALE PIATTA DESTRA	VR10810D	10	2	2	2	4	2	6
<b>M</b>	2 SET DI 2 MEZZE POMELLE CARRELLO CENTRALE + VITI	VR10828	20	1	1	1	1	1	1
<b>N1</b>	POMELLA CENTRALE DI MEZZO SINISTRA + PERNO AMOVIBILE + RONDELLE	VR10816G	20			1		2	
<b>N2</b>	POMELLA CENTRALE DI MEZZO DESTRA + PERNO AMOVIBILE + RONDELLE	VR10817D	20				1		2
<b>O</b>	2 MEZZE POMELLE TERMINALI + VITI	VR10818	20	1	1	1	1	1	1
<b>CHIUSURA</b>									
<b>P</b>	KIT CHIAVISTELLO PIATTO + GUIDA ASTA NYLON NERO	VR10835	10	4	4	4	4	4	4
<b>Q</b>	GUIDA ASTA + MANIGLIETTA ERGONOMICA NYLON NERO	VR10837	10			4	4	4	4
<b>R</b>	ASTA ALLUMINIO 1,10M PER CHIAVISTELLO PIATTO	VR10838J	10	4	4	4	4	2	2
<b>S</b>	ASTA ALLUMINIO 2M PER CHIAVISTELLO PIATTO	VR10839J	10					2	2

# INFORMAZIONI

## Attrezzi Necessari

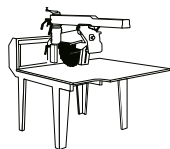

Sega circolare

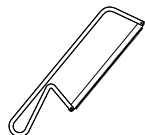

Seghetto per metallo

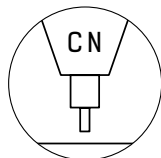

Comando numerico



Lima

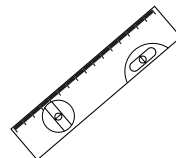

Livella

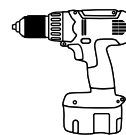

Trapano / Avvitatore

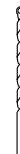

Punta per metallo

Ø13 mm  
Ø10 mm  
Ø7 mm  
Ø4,5 mm



Cacciavite

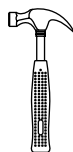

Martello

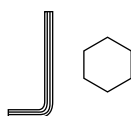

Chiave a brugola 2,5 e 8

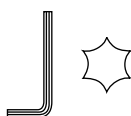

Chiave a brugola T20 e T25



Chiave combinata 14



Frenafiletti

## Caratteristiche tecniche

Larghezza massima : 500 mm

Altezza massima : 3 000 mm

Sbordo su facciata : 500 mm maxi.

Peso fino a 20kg / anta

Spessore : da 30 a 35 mm

## Consigli

TORBEL declinerà ogni responsabilità se verranno montati componenti non previsti e non appartenenti a questa gamma. È compito del fabbricante assicurarsi che i componenti siano compatibili con le persiane. Il sistema dovrà essere posato da un professionista a regola d'arte rispettando tutte le NTC. Escludere la posa in prima linea costiera e nelle zone più ventose (Norma EN1991-1-4).

Rispettare le dimensioni massime per anta (3 m x 0,5 m x uno spessore compreso tra 30 e 35 mm) per un peso massimo di 20 kg per anta. Per il corretto funzionamento verificare che la struttura delle ante sia sufficientemente rigida e solida. Fissare saldamente il telaio (su una struttura sufficientemente resistente alle sollecitazioni del sistema) nei differenti singoli punti (i singoli punti si trovano a livello delle pomelle, delle battute inferiori e dei carrelli anta aperti e chiusi...) con la viteria adatta al sistema e al materiale della facciata. Utilizzare un fissaggio in ogni foro delle pomelle e dei chiavistelli previsti con la viteria adatta (vite per legno TF Ø5 o rivetto Ø4,8) in base al tipo di anta.

Prevedere delle aperture necessarie a far evacuare l'acqua soprattutto nella guida inferiore.

Il sistema si dovrà aprire e chiudere senza particolare sforzo (nessun attrito) e assicurarsi che non ci sia alcun ostacolo. Pulire e lubrificare regolarmente le pomelle e le ruote dei carrelli e delle guide inferiori. Sostituire i pezzi che presentano delle anomalie (usure importanti, rotture).

Verificare regolarmente la viteria, stringere o sostituire al bisogno.

Gli utenti sono tenuti a chiudere le persiane in caso di assenza e/o di avviso di vento forte (allerta arancione). Assicurarsi che i chiavistelli automatici siano posizionati correttamente quando le persiane sono chiuse, altrimenti aggiustarle manualmente.

È compito del produttore fornire all'utilizzatore finale i consigli di utilizzo e di pulizia dei nostri prodotti.

**Altezza Anta = Altezza telaio - 87 mm**

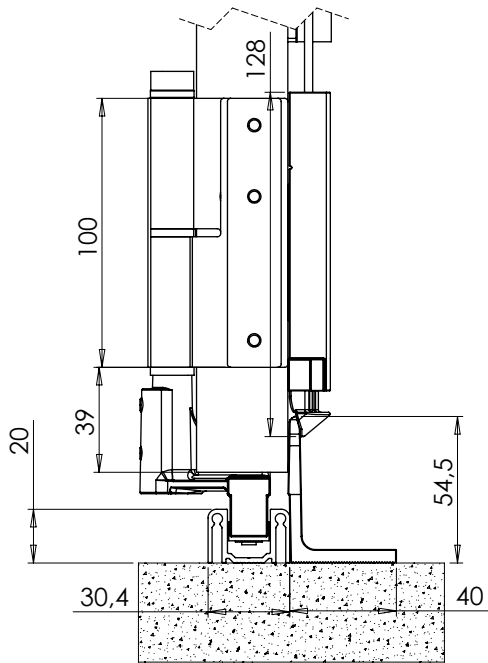
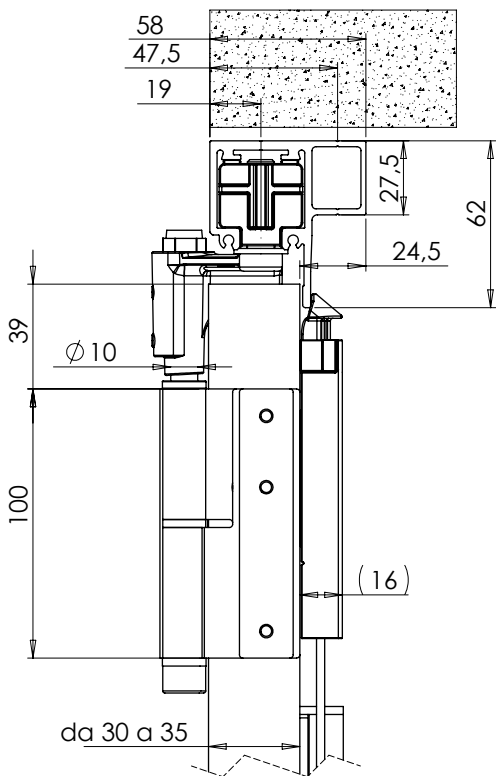

Lato esterno

Lato interno

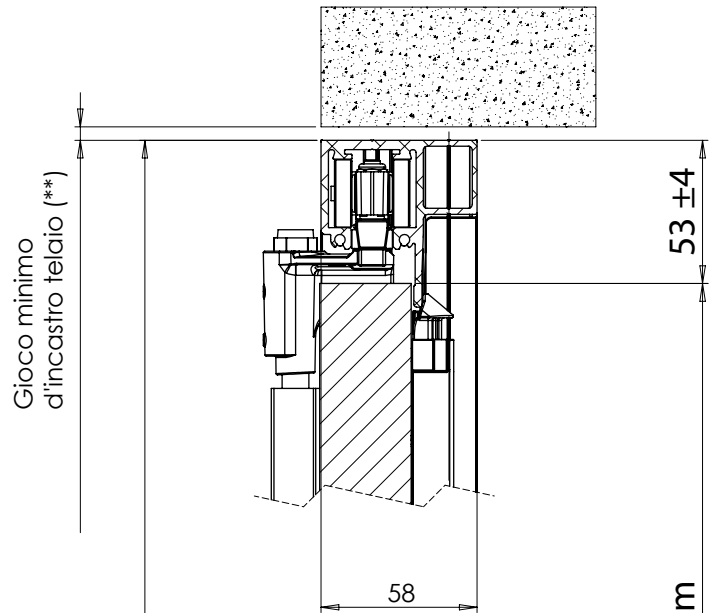

Altezza telaio

Altezza Anta = Altezza telaio - 87 mm

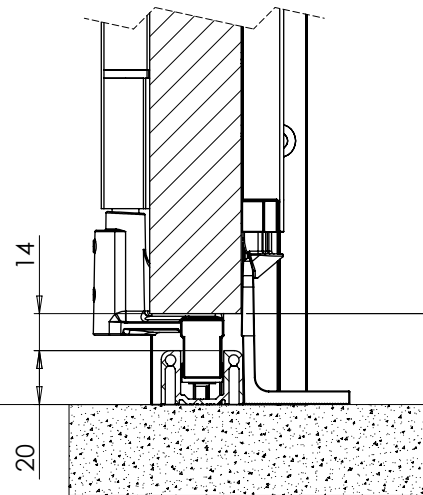

Lato esterno

Lato interno

(\*\*) Sulle aperture di dimensioni minime suggeriamo un gioco minimo di incastro periferico del telaio di 5 mm

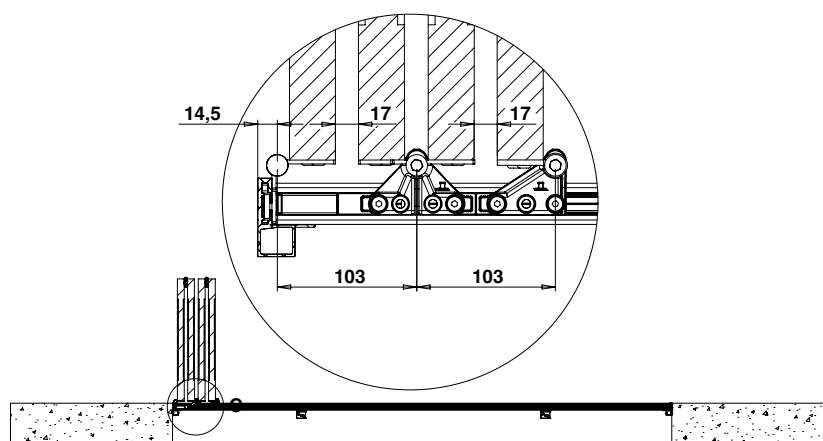

INTERNO

Larghezza anta =  
 $(L - J^{(*)} - 57 \text{ mm}) / 4$

LATO ESTERNO

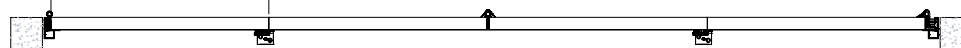

LATO INTERNO

Gioco minimo  
di incastro telaio (\*\*)

Gioco minimo  
di incastro telaio (\*\*)

$J = \text{Gioco di funzionamento } (^*)$

LATO ESTERNO



LATO INTERNO

$L = \text{Larghezza telaio}$

(\*) Il gioco di funzionamento J deve integrare l'arretramento del carrello durante la chiusura, le tolleranze dimensionali delle ante e del telaio nonché le dilatazioni legate alle variazioni igrometriche e termiche.

(\*) Arretramento del carrello: Larghezza anta 500 mm => 5 mm, 400 mm => 6.5 mm, 300 mm => 8.5 mm, 200 mm => 13 mm.

(\*\*) Sulle aperture di dimensioni minime suggeriamo un gioco minimo di incastro periferico del telaio di 5 mm.

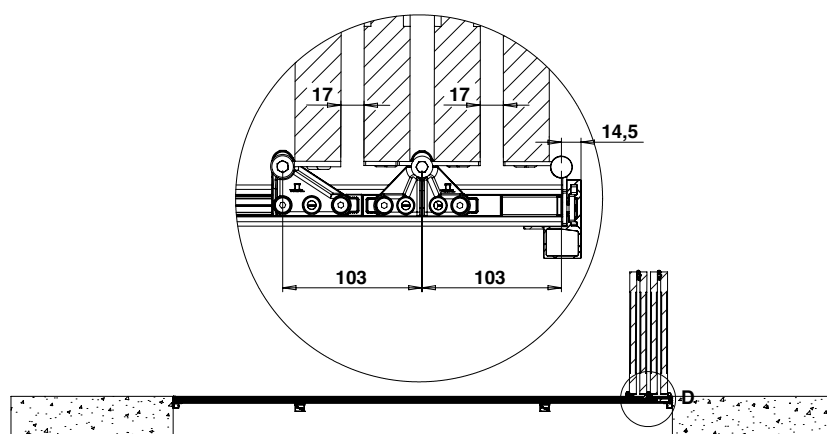

INTERNO

Larghezza anta =  
 $(L - J^{\circ} - 57 \text{ mm}) / 4$



Gioco minimo  
di incastro telaio (\*\*)

J = Gioco di funzionamento (\*)

Gioco minimo  
di incastro telaio (\*\*)

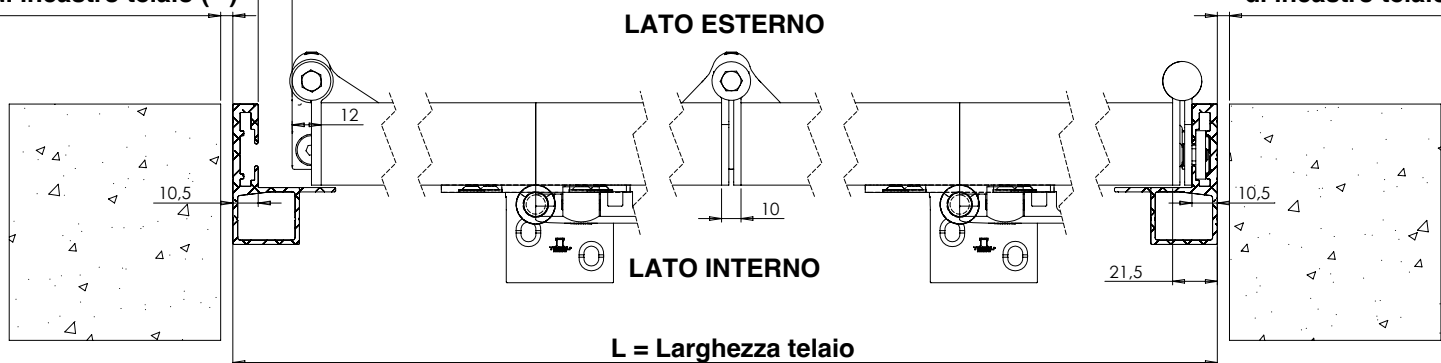

(\*) Il gioco di funzionamento J deve integrare l'arretramento del carrello durante la chiusura, le tolleranze dimensionali delle ante e del telaio nonché le dilatazioni legate alle variazioni igrometriche e termiche.

(\*) Arretramento del carrello: Larghezza anta 500 mm => 5 mm, 400 mm => 6.5 mm, 300 mm => 8.5 mm, 200 mm => 13 mm.

(\*\*) Sulle aperture di dimensioni minime suggeriamo un gioco minimo di incastro periferico del telaio di 5 mm.

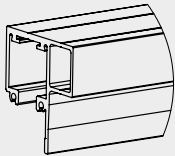
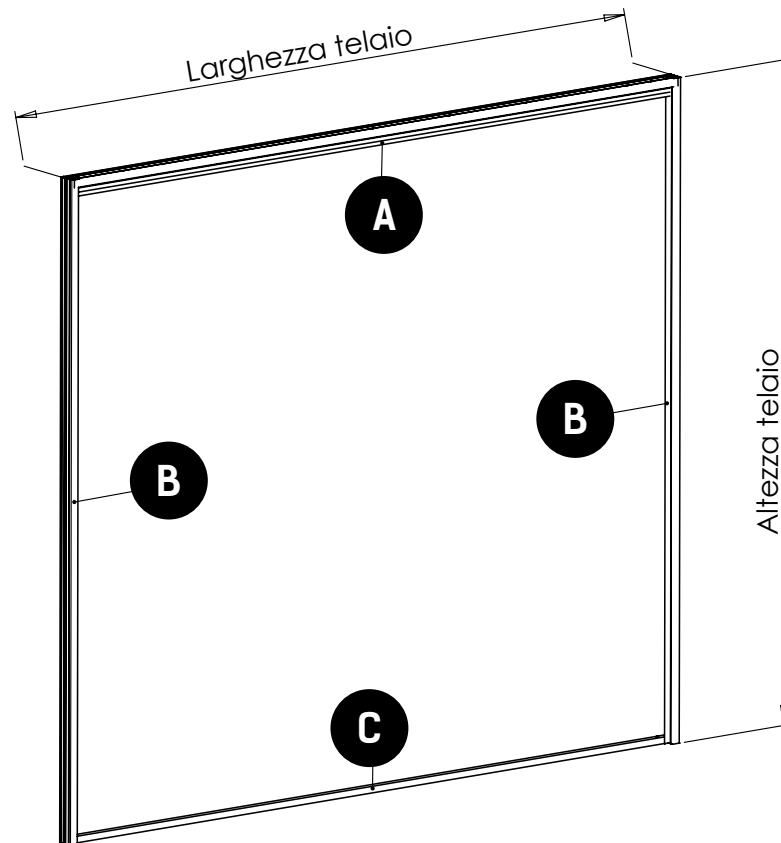
**A** VR10906

**Lunghezza binario superiore =  
Larghezza del telaio - 21 mm**

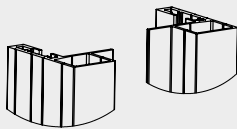
**B** VR10917

**Lunghezza profilo telaio laterale =  
Altezza telaio**

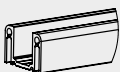

**C** VR10926

**Lunghezza guida inferiore =  
Larghezza del telaio - 21 mm**

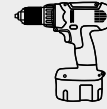

# 2

## Foratura e lavorazione dei profili



I punti di fissaggio devono essere a livello dei singoli punti.

### 2.1

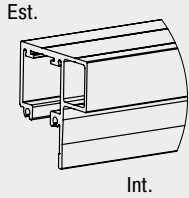

**A** VR10906

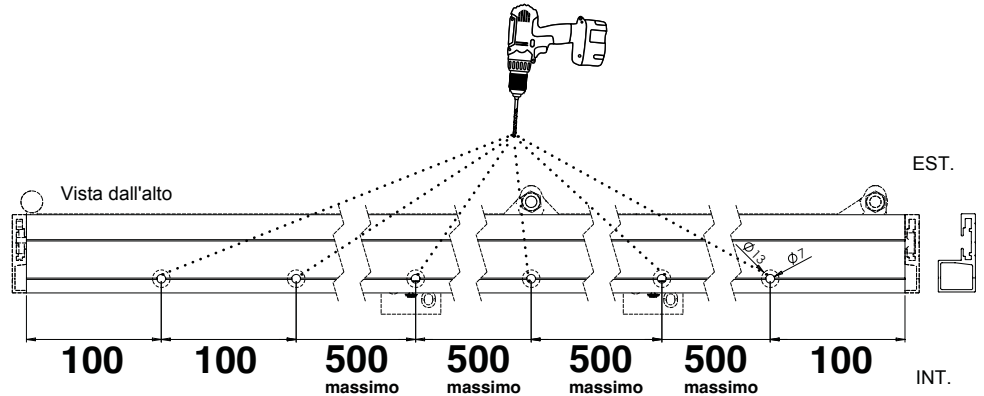

### 2.2

Prima della lavorazione

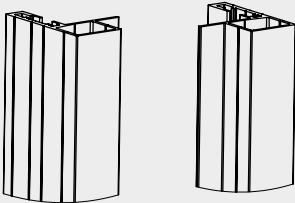

Sinistra

Destra

Dopo della lavorazione

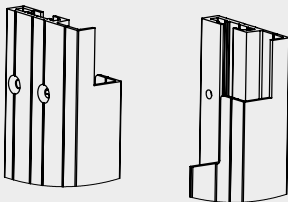

Sinistra

Destra

**B** VR10917

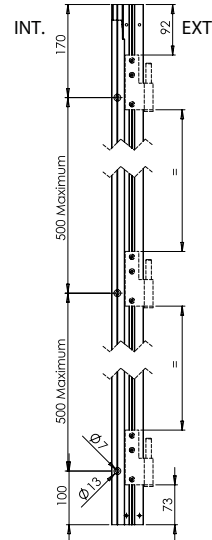

VR10917 (Sinistra)

VR10917 (Destra)

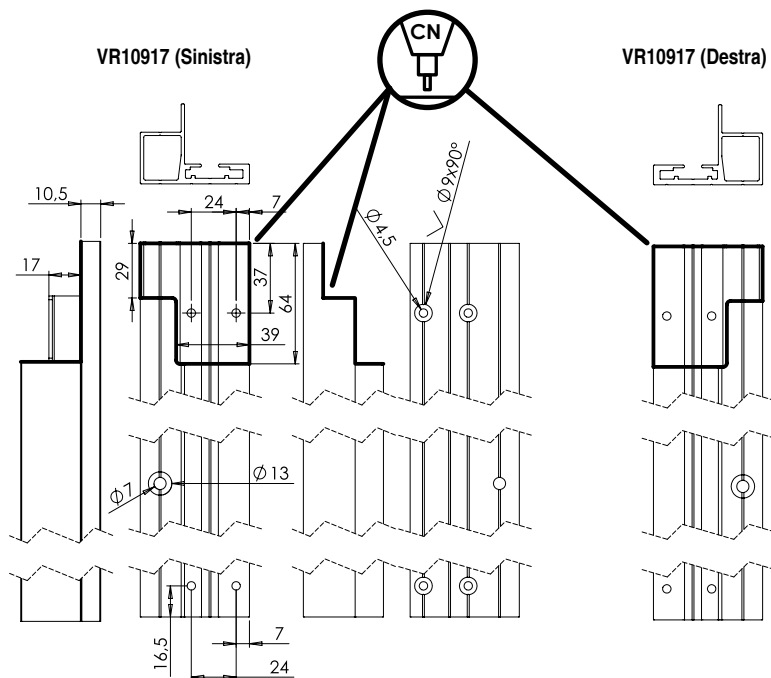

# 2

## Foratura e lavorazione dei profili

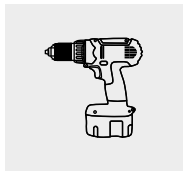

I punti di fissaggio devono essere a livello dei singoli punti.

### 2.3

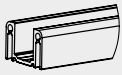

VR10926

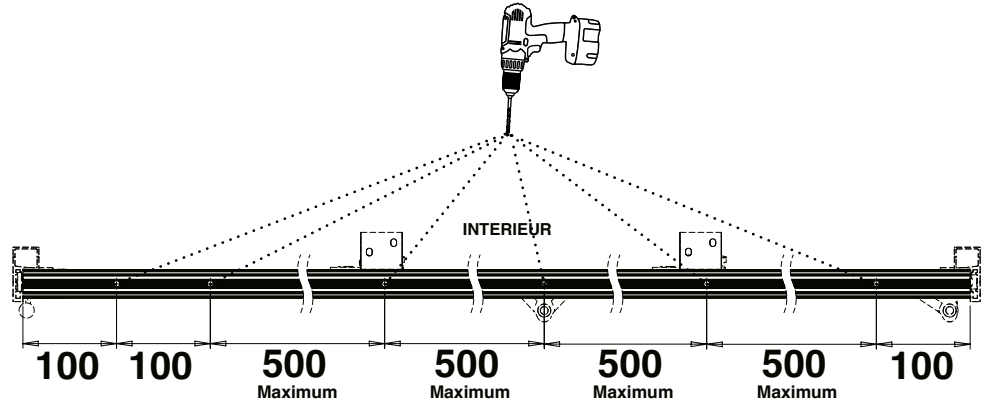

## Drenaggio del binario di guida inferiore

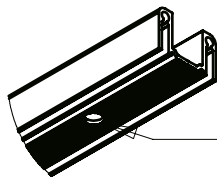
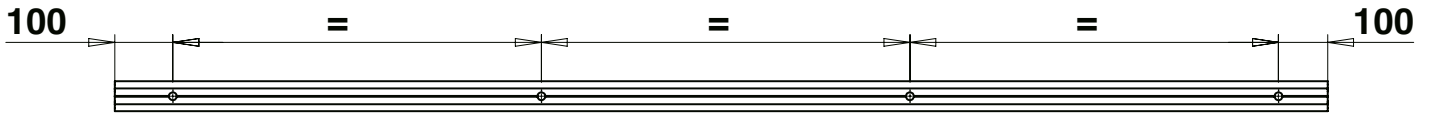
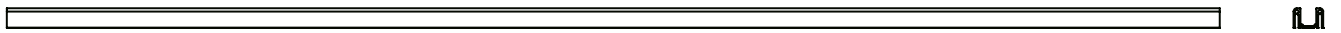

Drenaggio verticale Ø8

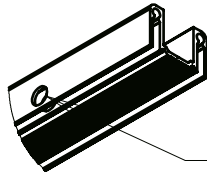

Drenaggio orizzontale Ø8  
(orientato verso l'esterno)

# 3 Montaggio del telaio

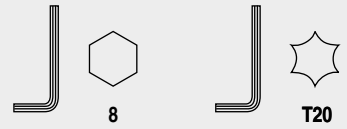

Per facilitare il montaggio e permettere la posa a terra del telaio, i passaggi qui di seguito sono orientati con vista dall'esterno.

## 3.1

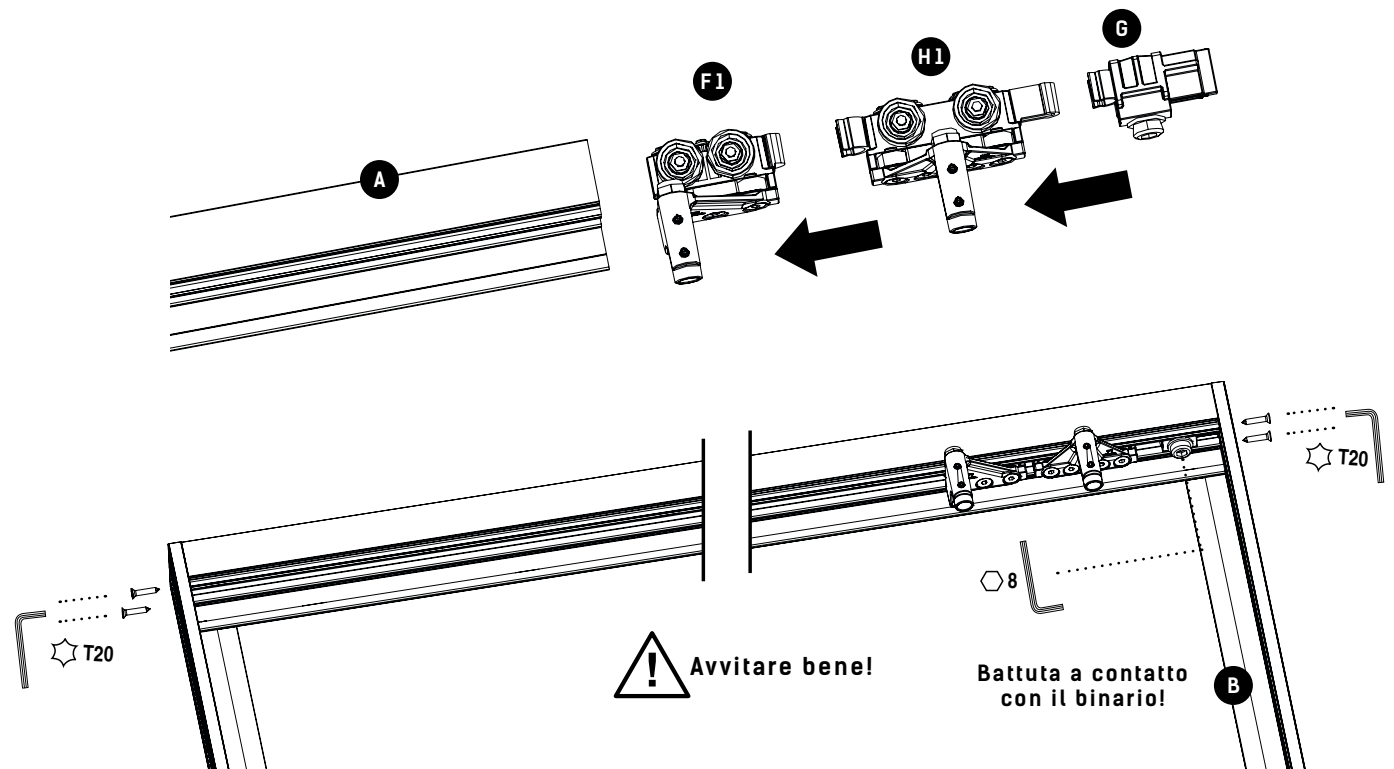
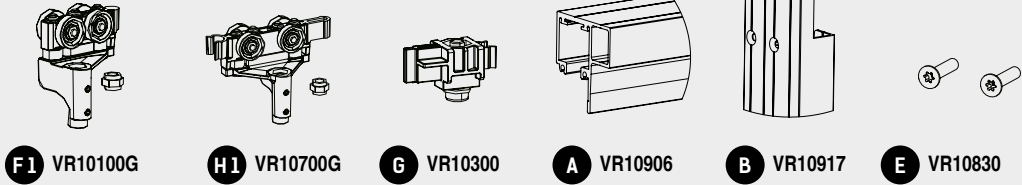

## 3.2

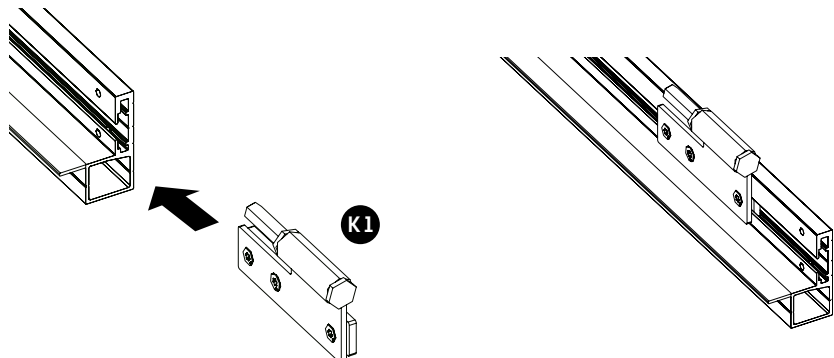
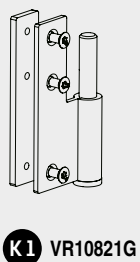

# 3 Montaggio del telaio

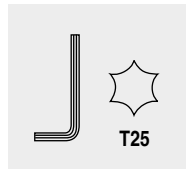

Per facilitare il montaggio e permettere la posa a terra del telaio, i passaggi qui di seguito sono orientati con vista dall'esterno.

## 3.3

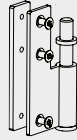

**K1** VR10821G

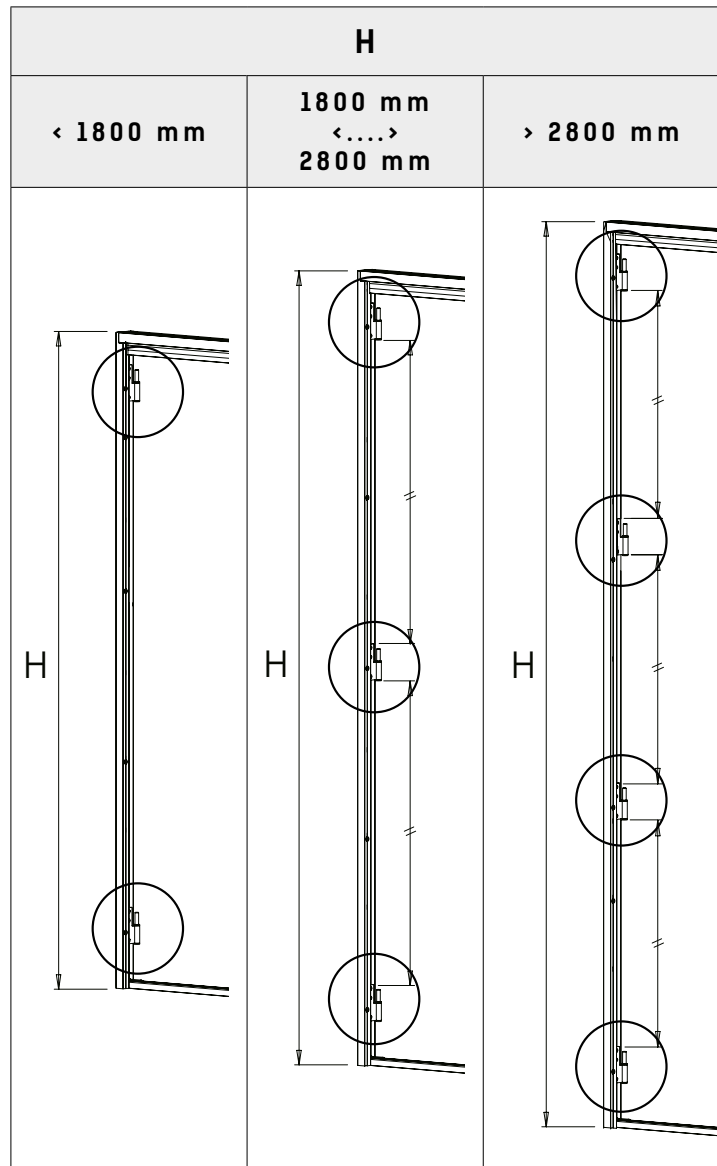
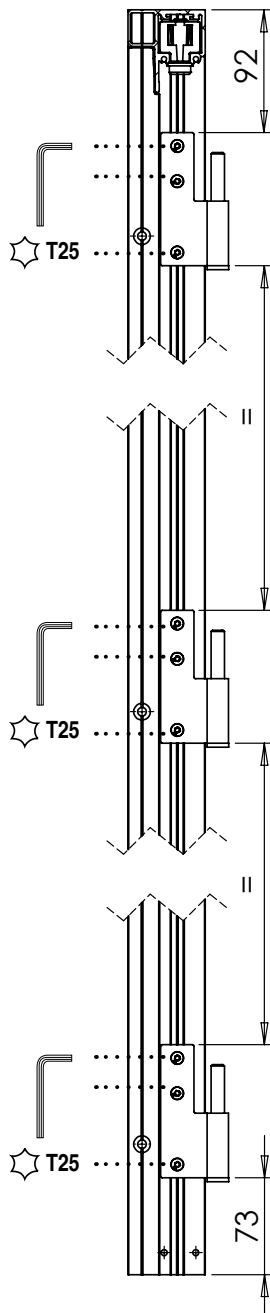

# 3 Montaggio del telaio

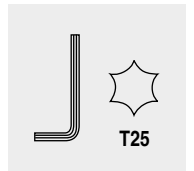

Per facilitare il montaggio e permettere la posa a terra del telaio, i passaggi qui di seguito sono orientati con vista dall'esterno.

## 3.4

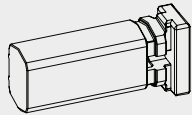

**E** VR10830

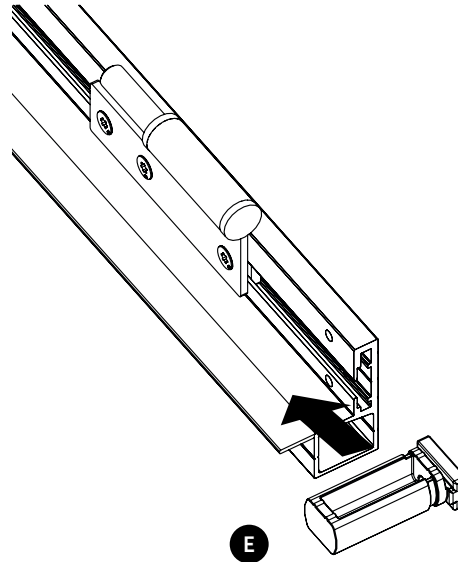

Attenzione al senso di posa della battuta!

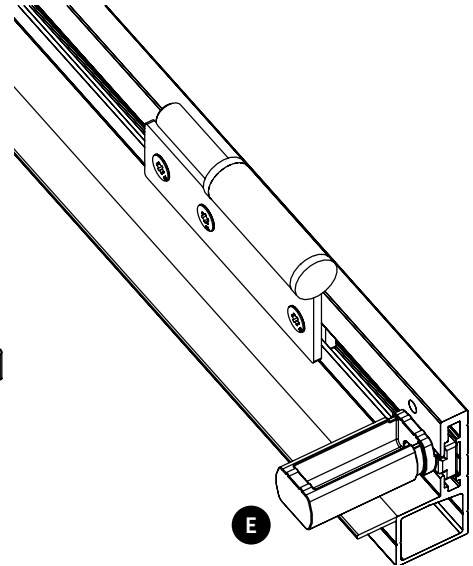

## 3.5

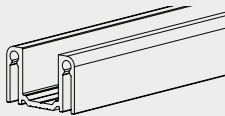

**C** VR10926

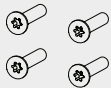

**E** VR10830

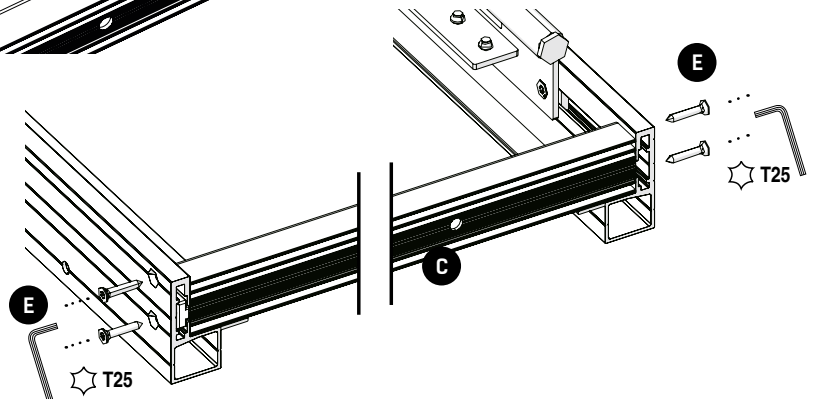
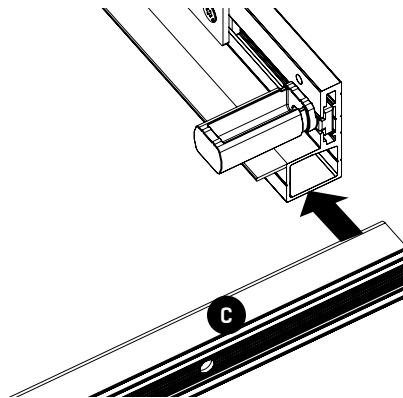

Primo paio di ante

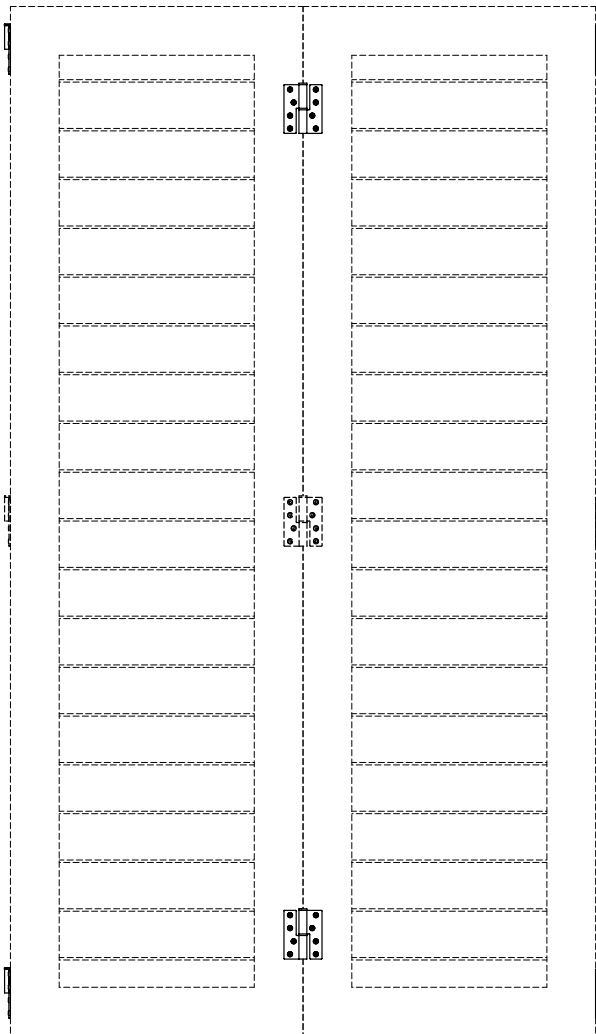

Secondo paio di ante

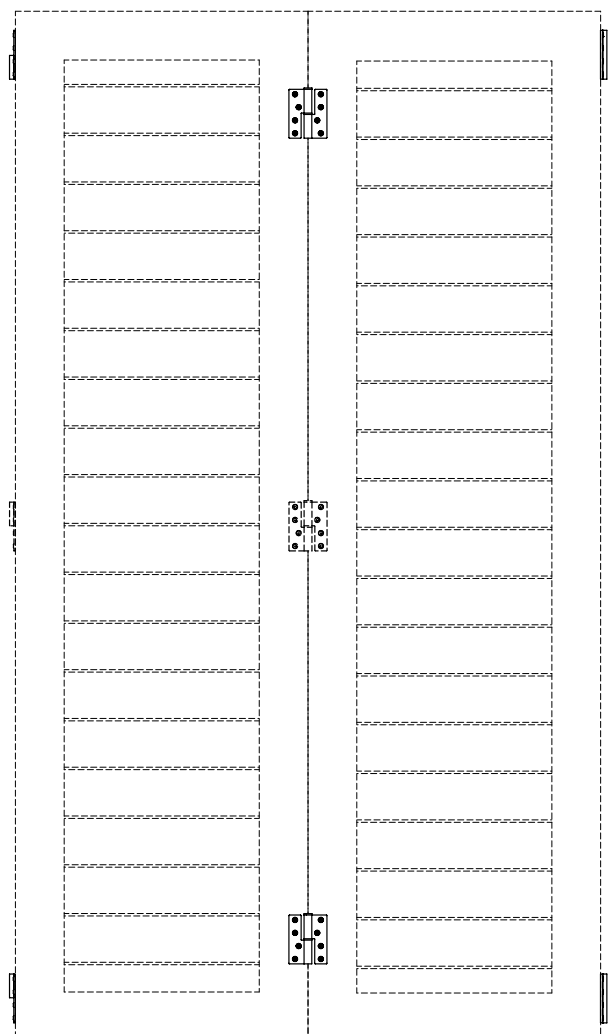

H

&lt; 1800 mm

1800 mm &lt;....&gt; 2800 mm

&gt; 2800 mm

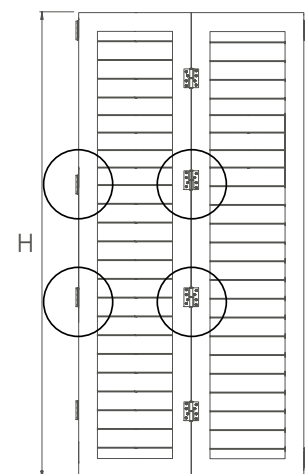
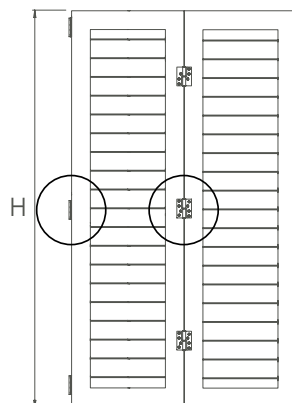
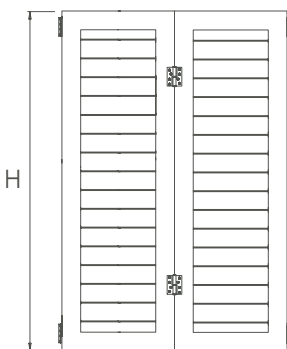

## 4.1

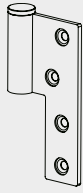

K1 VR10821G

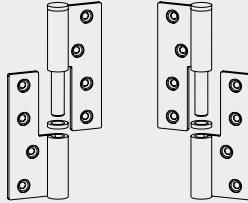

L1 VR10809G

L2 VR10810D

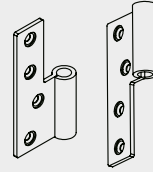

M VR10828

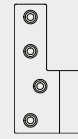
En option  
si H>1800 mm

N1 VR10816G

Vista dall'interno

Perno verso il basso!

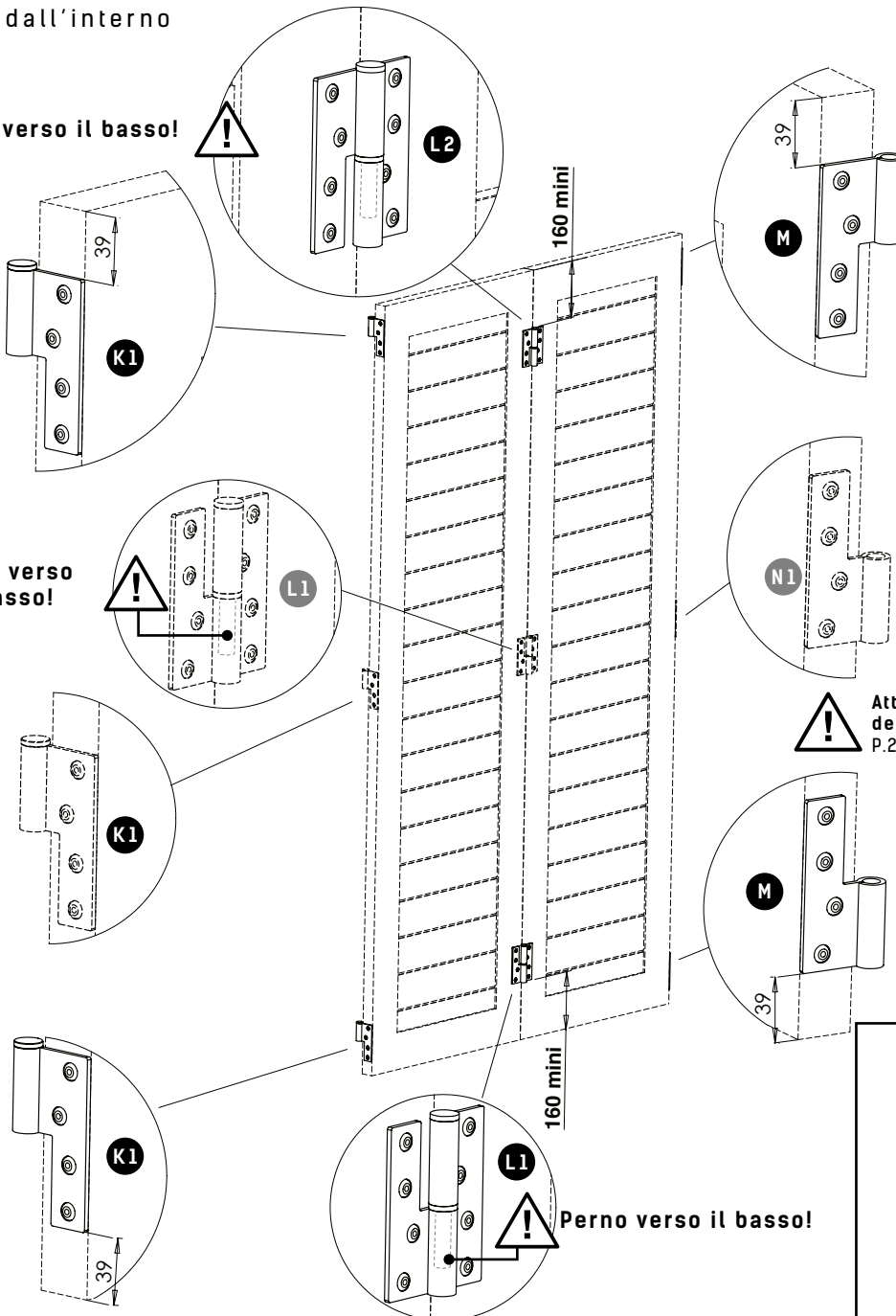

⚠ Attenzione alla posizione  
del chiavistello!  
P.22

**Possibilità  
di montaggio  
del chiavistello  
in officina**

**P.22**

## 4.2

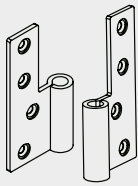
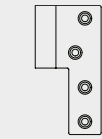
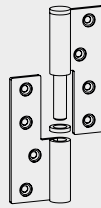
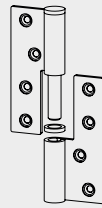
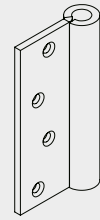
**M** VR10828En option  
si H > 1800 mm**N1** VR10816G**L1** VR10809G**L2** VR10810D**O** VR10818

Vista dall'interno

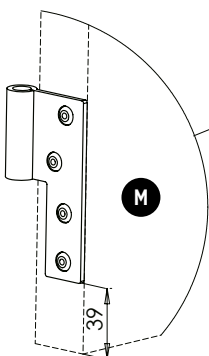
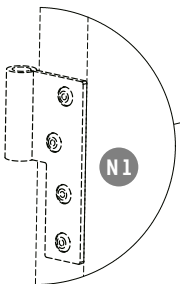
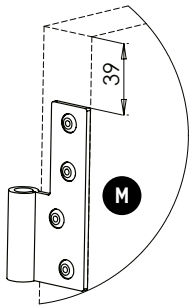
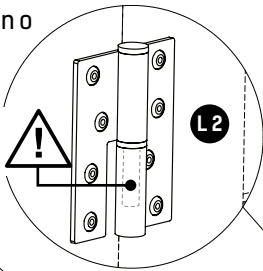
Perno verso  
il basso!

Perno verso il basso!

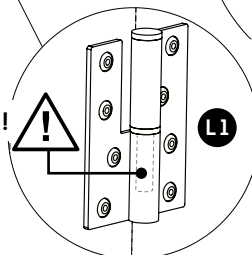
Attenzione alla posizione  
del chiavistello!  
P.22

Perno verso il basso!

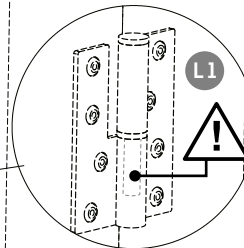
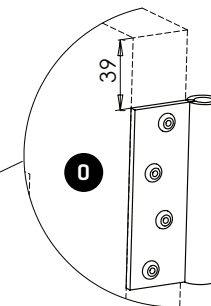
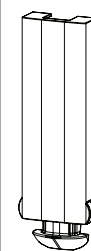
Attenzione alla posizione  
del chiavistello!  
P.22Attenzione alla posizione  
del chiavistello!  
P.22Possibilità  
di montaggio  
del chiavistello  
in officina

P.22



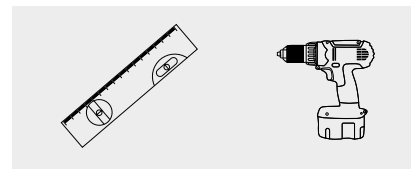

## 5 Installazione del telaio (regolazione geometrie e calibrzione)

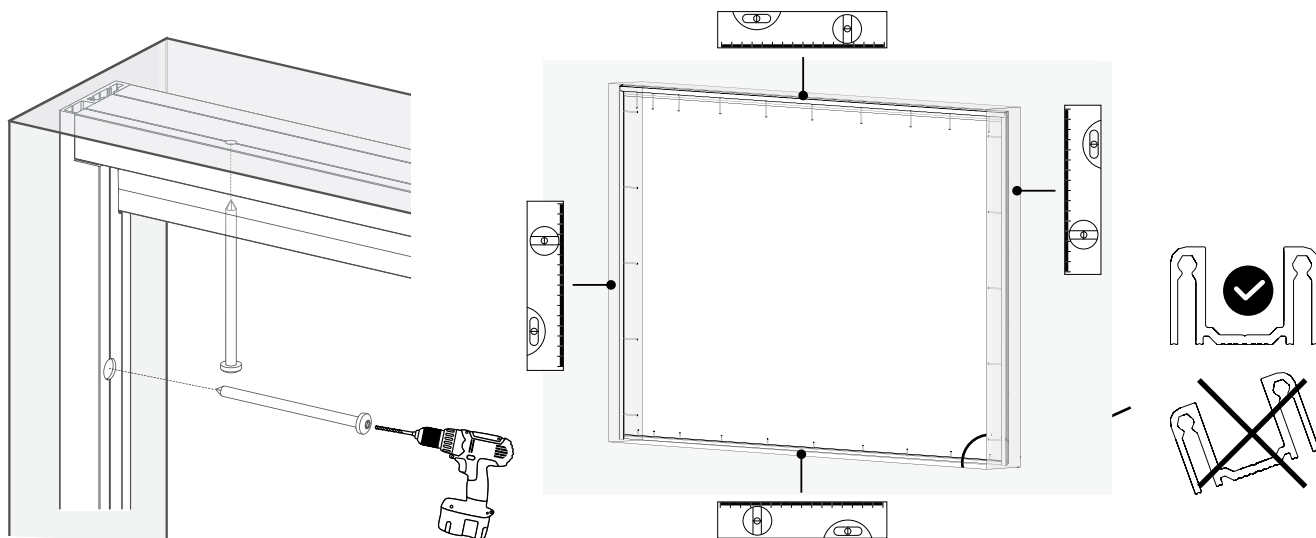

## 6 Montaggio delle ante

Vista dall'interno

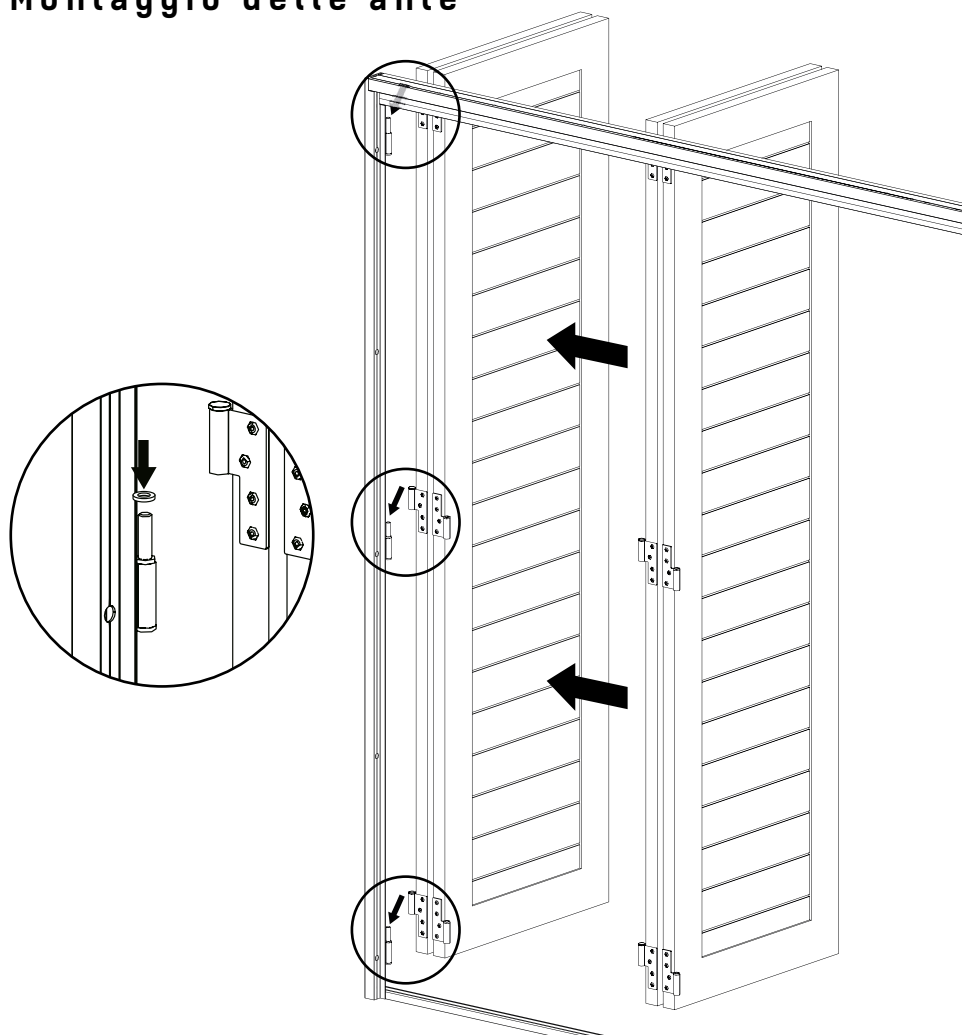

7

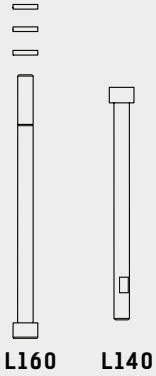

**M** VR10828

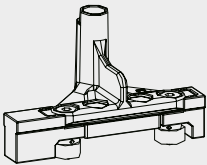

**J1** VR10800G

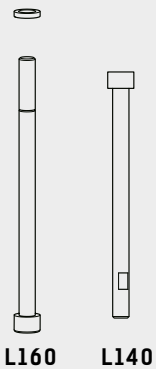

**O** VR10818

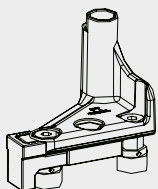

**I1** VR10400G

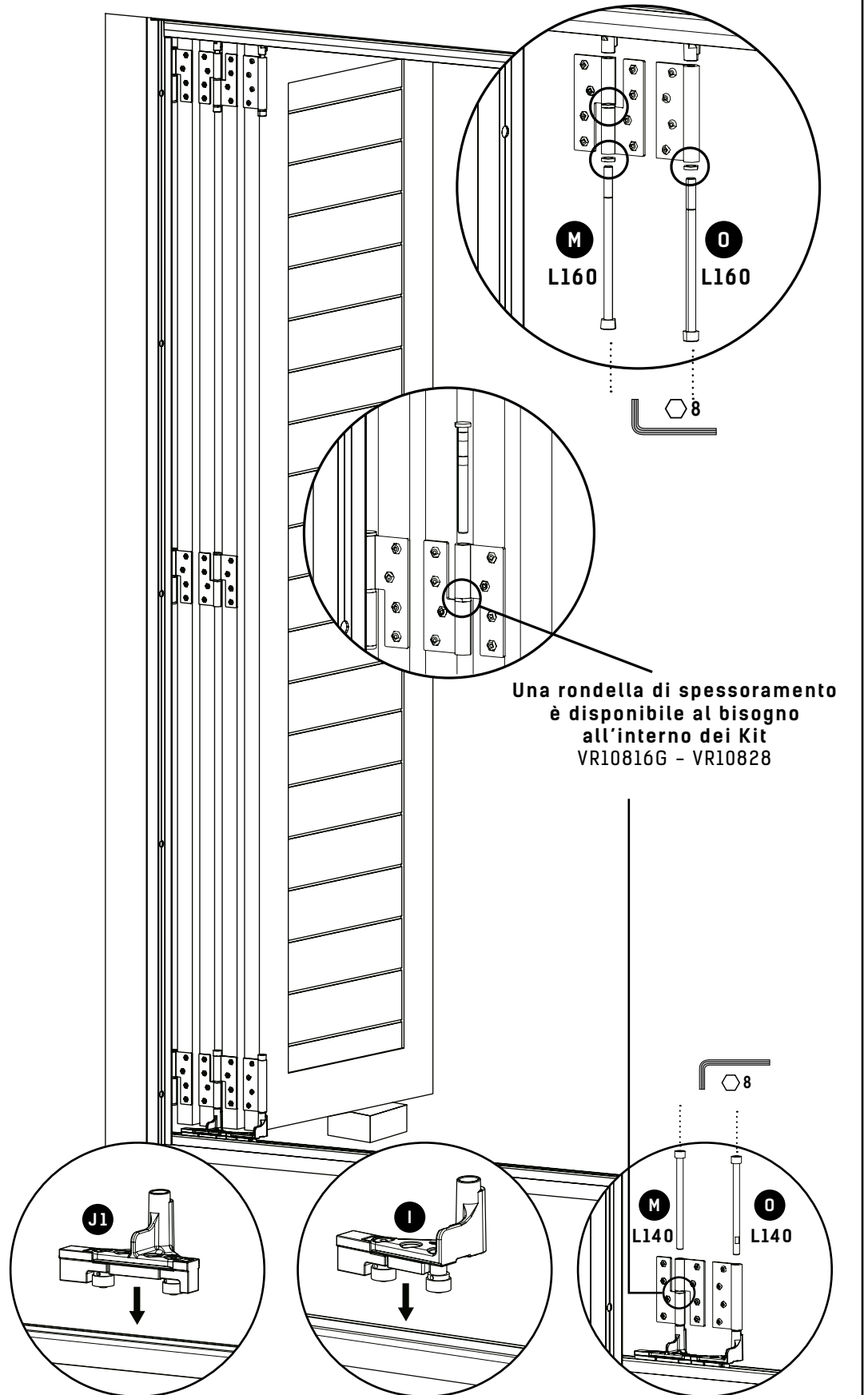

## 8.1

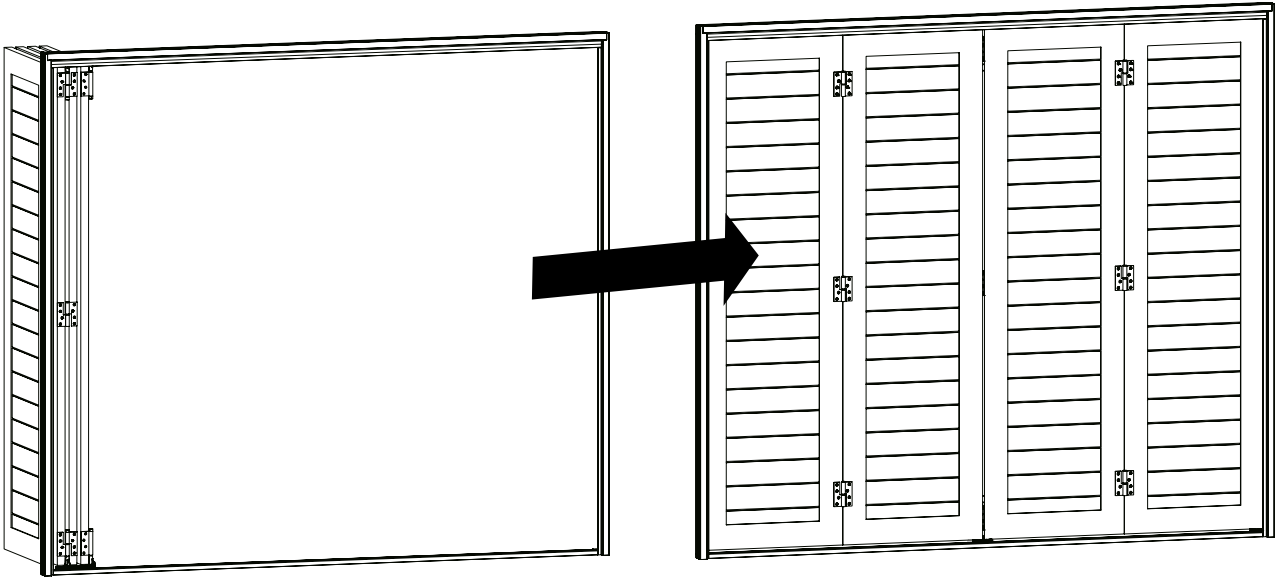

## 8.2



Individuare la linea sul profilo, permetterà di posizionare correttamente le ante orizzontalmente.

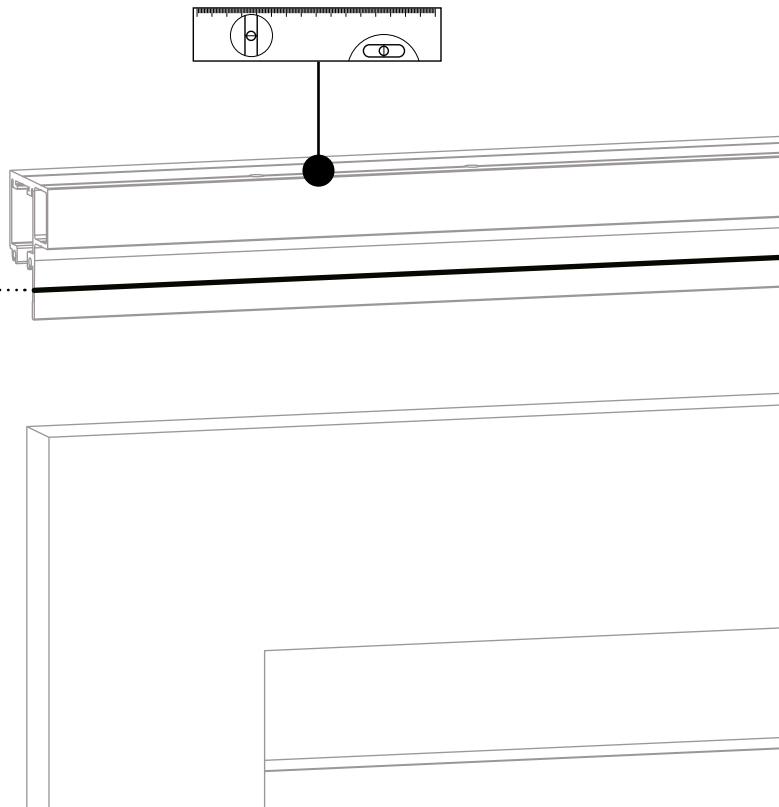

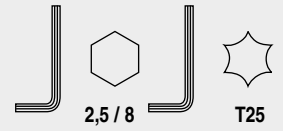

## 8.3

Vista dall'esterno

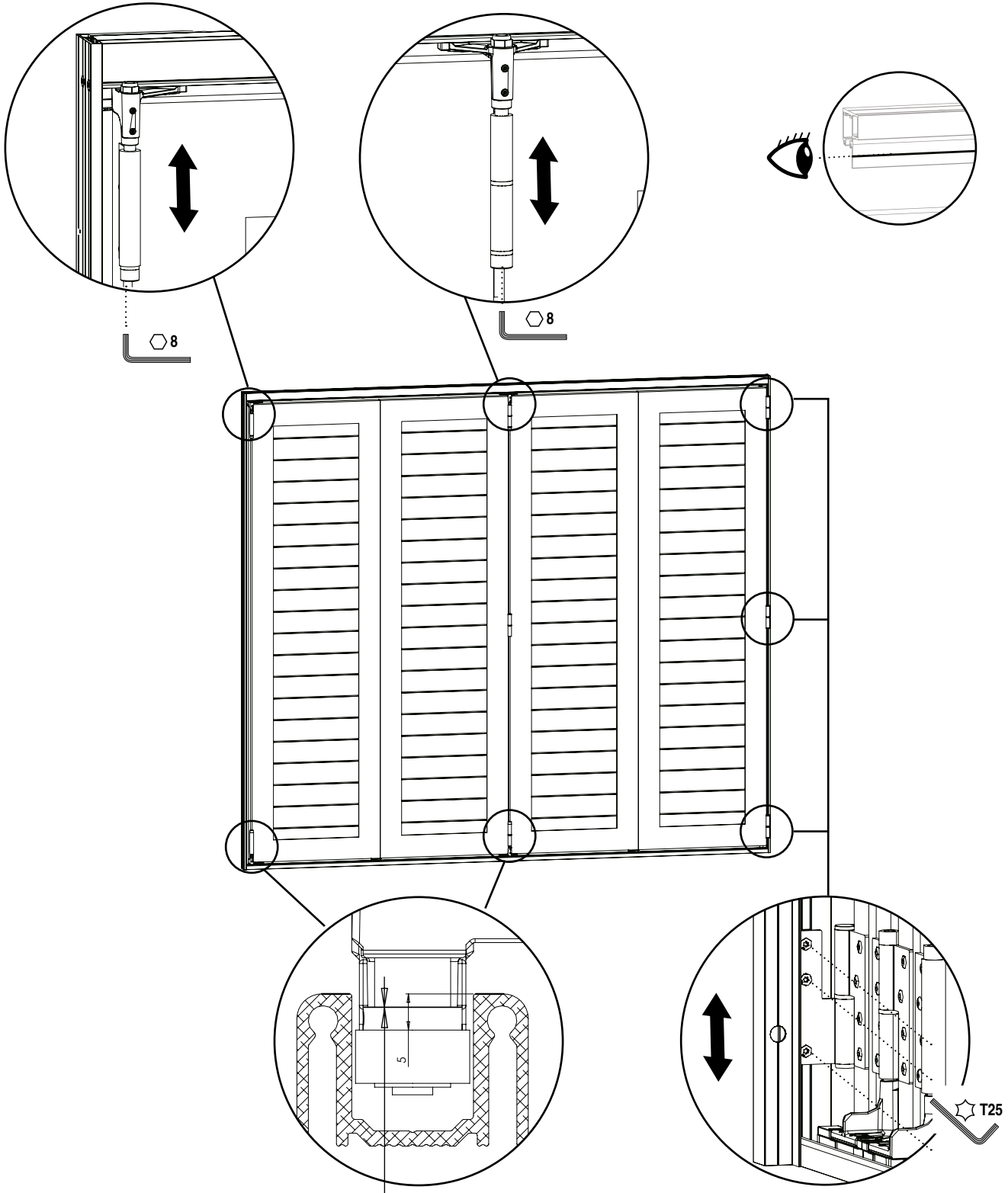

Verificare che la parte alta della ruota sia inserita di 5 mm nel binario per garantire una presa ottimale.



**8.4**

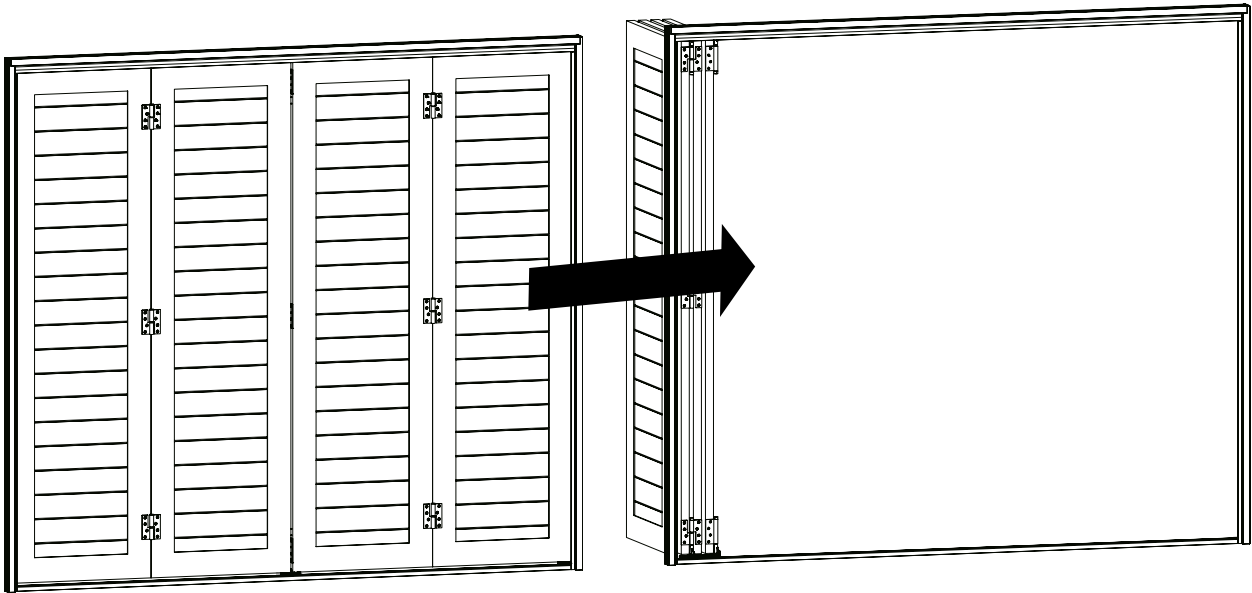

**Fissaggio di sicurezza**

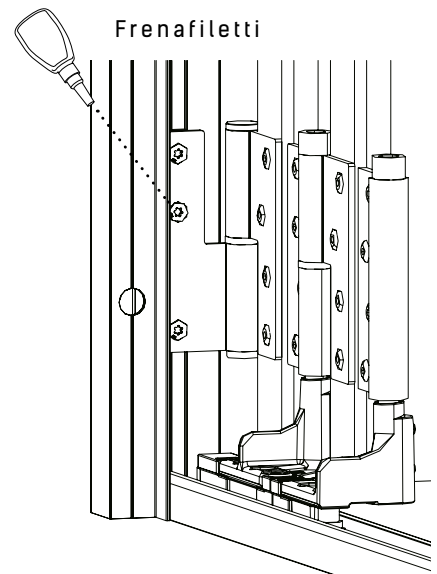
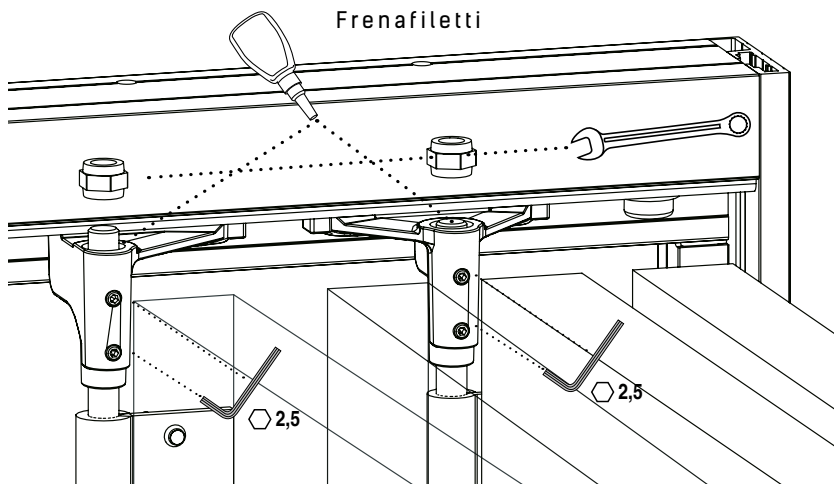

9.1

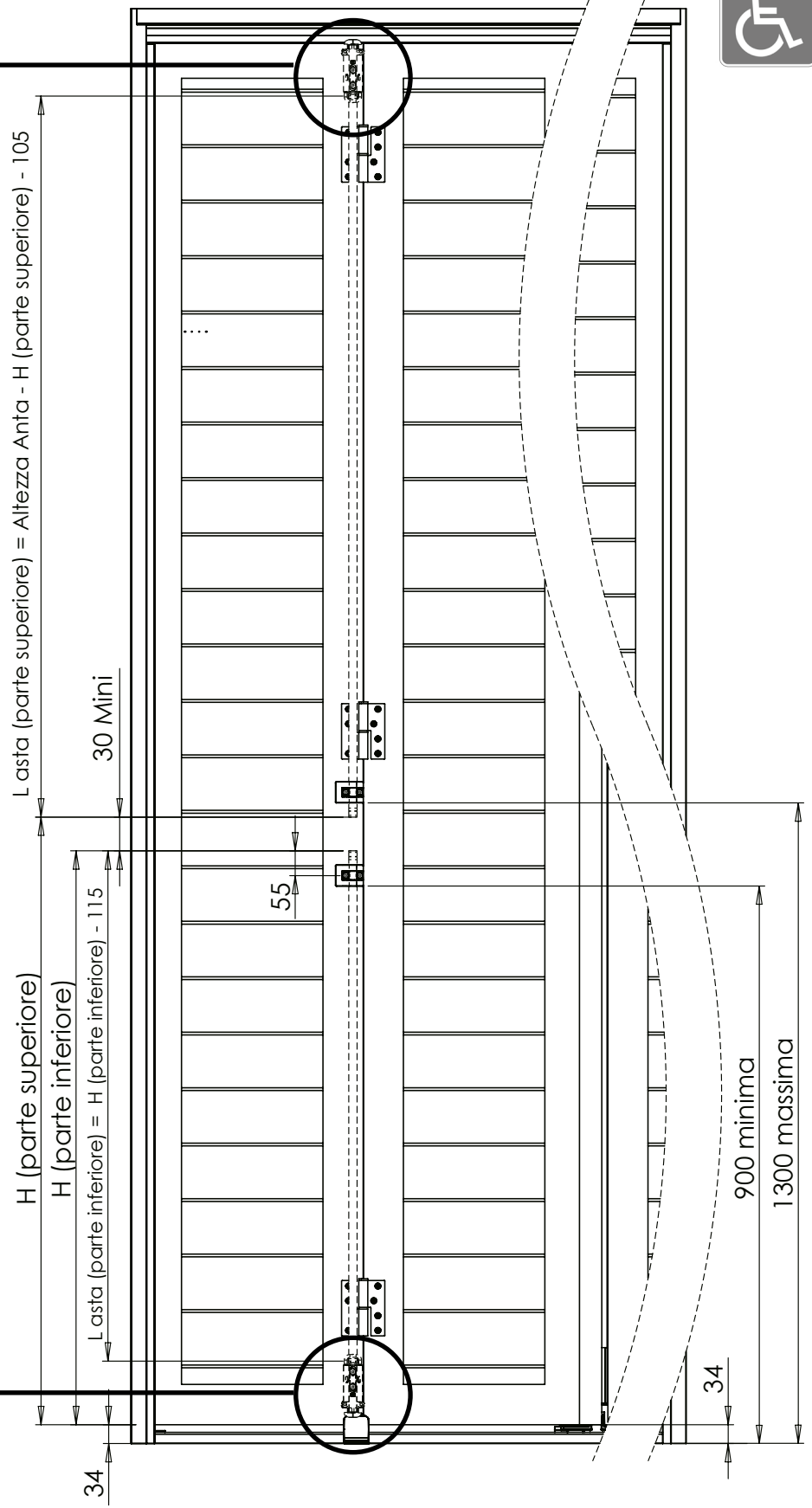
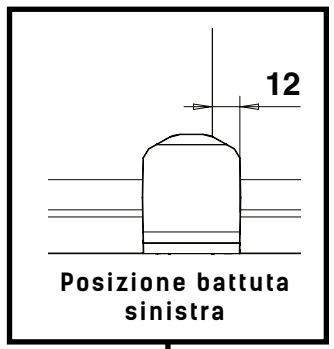
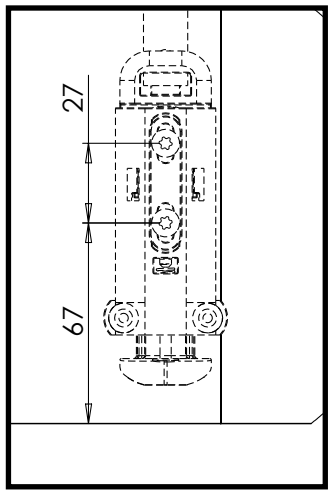
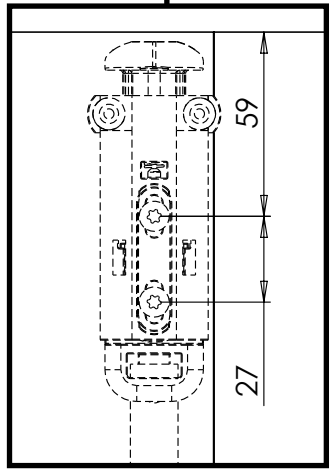

# 9

## Montaggio del chiavistello e della battuta

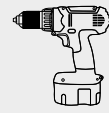
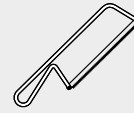

### 9.2

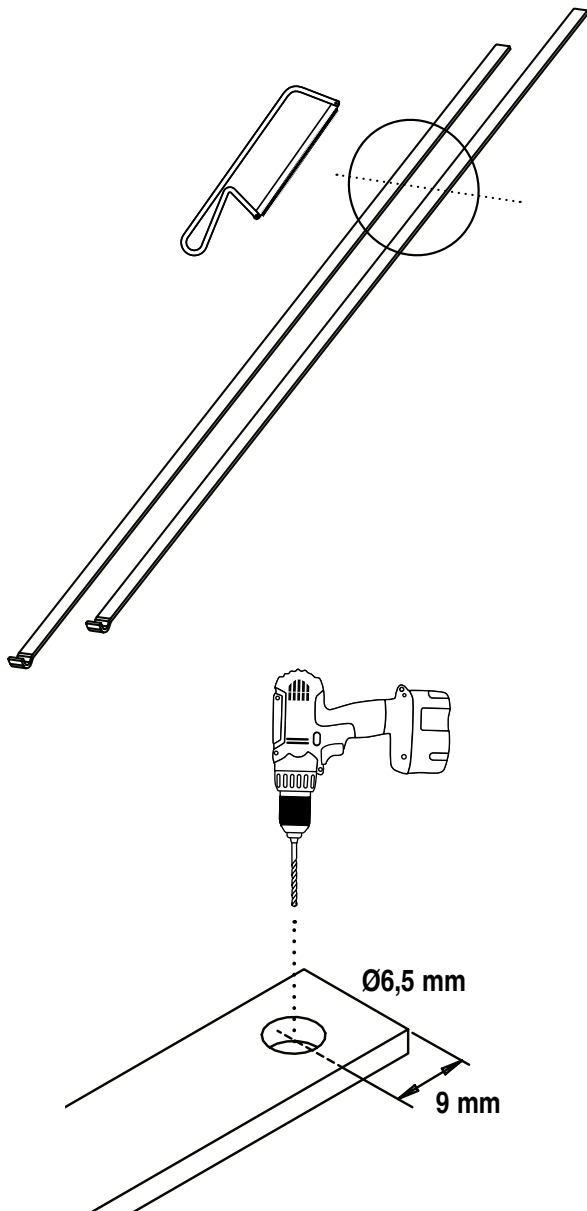
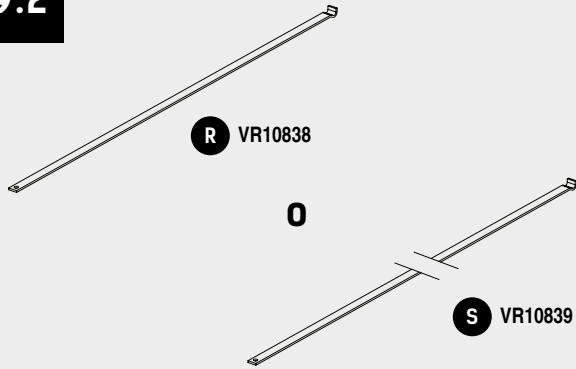

### 9.3

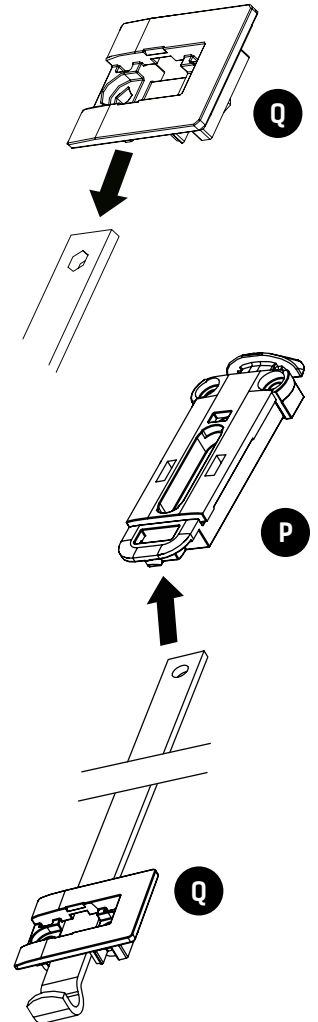
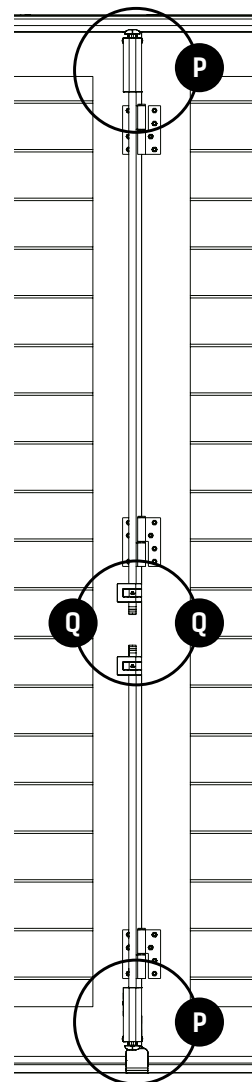
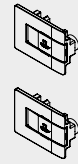
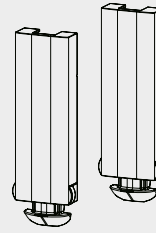

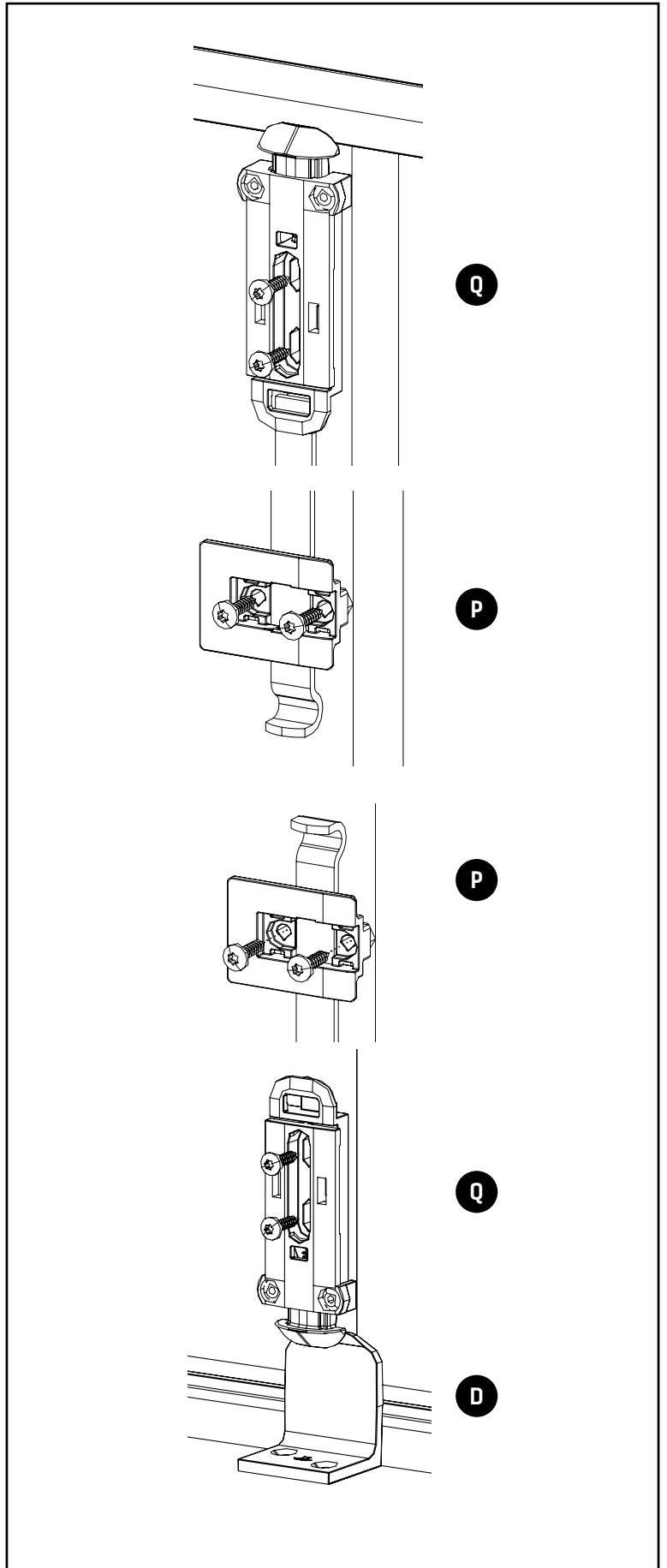
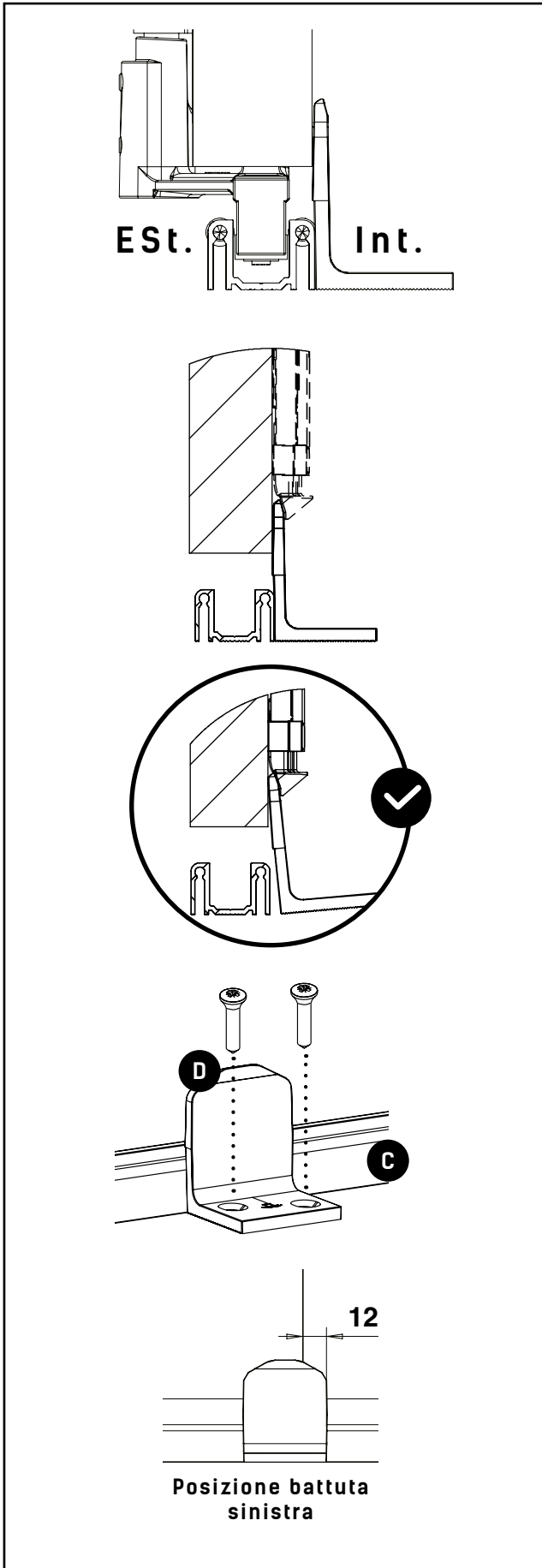
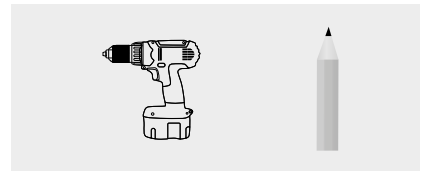



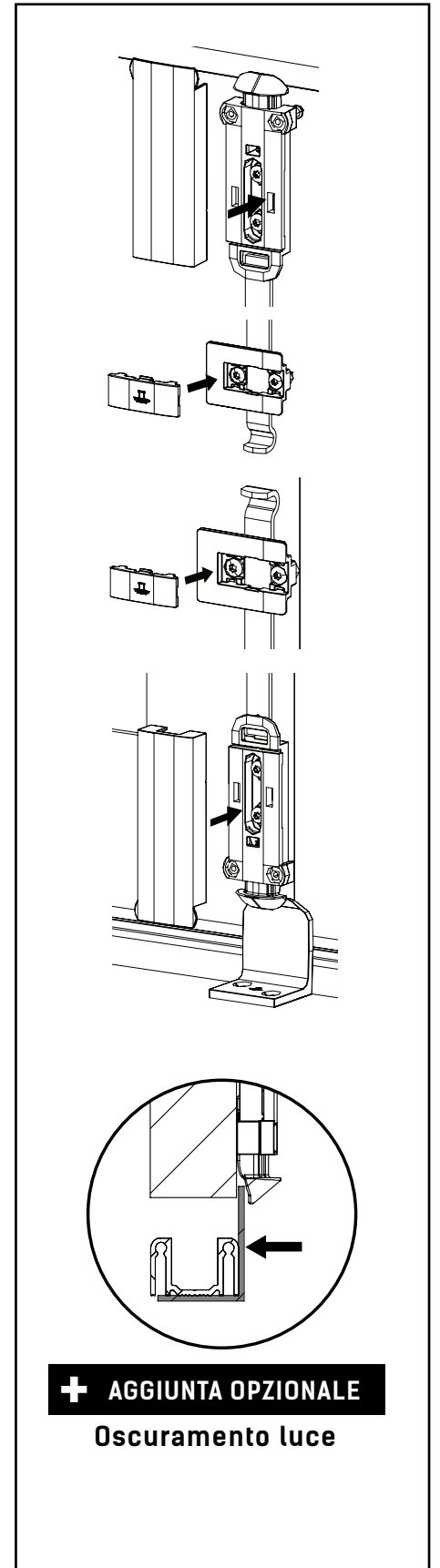
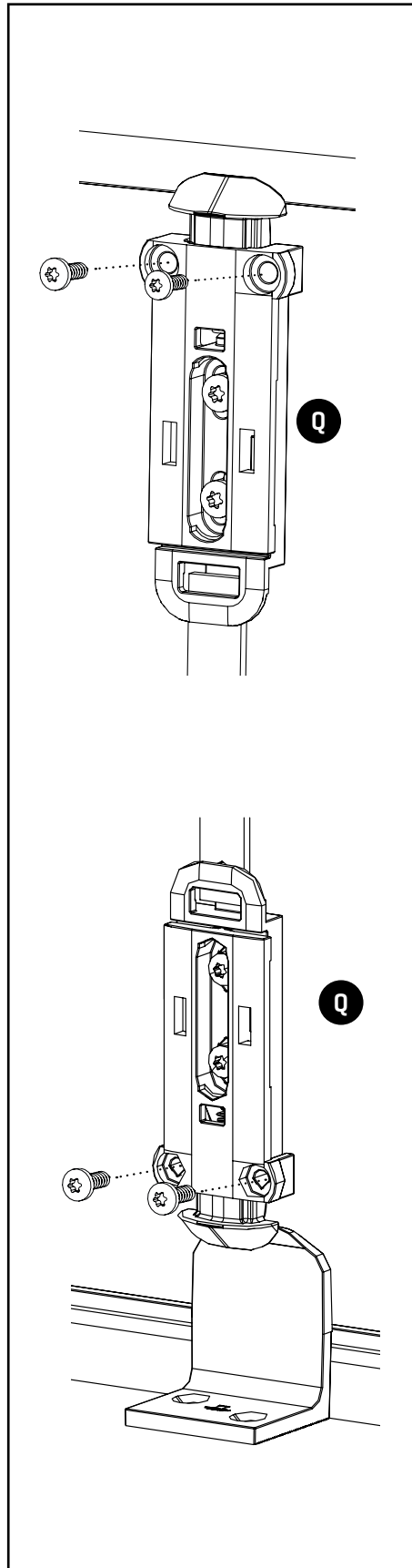
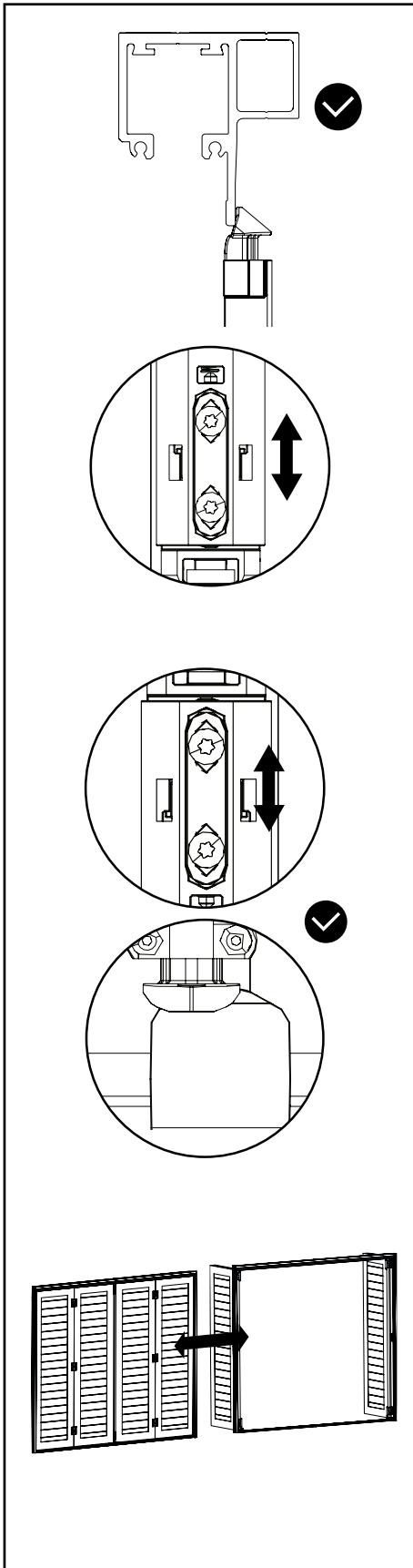
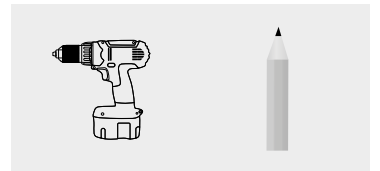

L'installazione è completata !





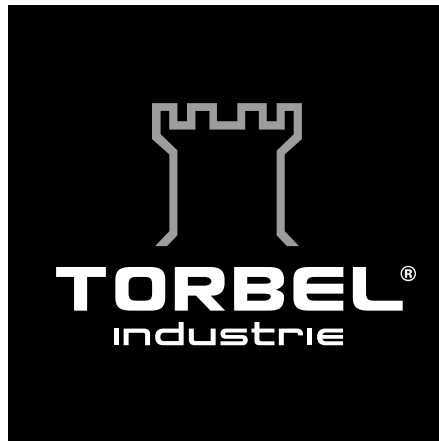

**TORBEL® SRL**

Via Brandizzo, 121/G - 10088 Volpiano (TO)  
Tel : +39 011 995 56 12 - info@torbel.it - www.torbel.it